

O&M Instructions for Cylindrical Air Intake Units

E2050-5 Gr 138



The filter units are non mechanical and once installed require no further attention apart from regular maintenance. The filter canister is manufactured from painted mild steel with a drilled flange for connection to site pipework. Under normal conditions of use the canister should give years of operational service.

The filter element is manufactured using 30ppi polyfoam and requires attention to ensure efficient filtration.

The element is removed by unscrewing the hex head set screw at the top & removing the spinning, the filter element can then be removed. The filter element should be removed carefully to minimise any dust disturbance.

Replacement of the element is the reverse of removal.

Maintenance—maximum performance is maintained by regular cleaning, typically filters are rapped, vacuumed or blown through; washing in a weak detergent ensures thorough cleaning.

The element is fully disposed of once it reached final pressure drop, final pressure drop is 400pa.

Filters and elements are available from EMCEL Filters Limited. The spare filter reference for this unit is E2051-1 Gr616.

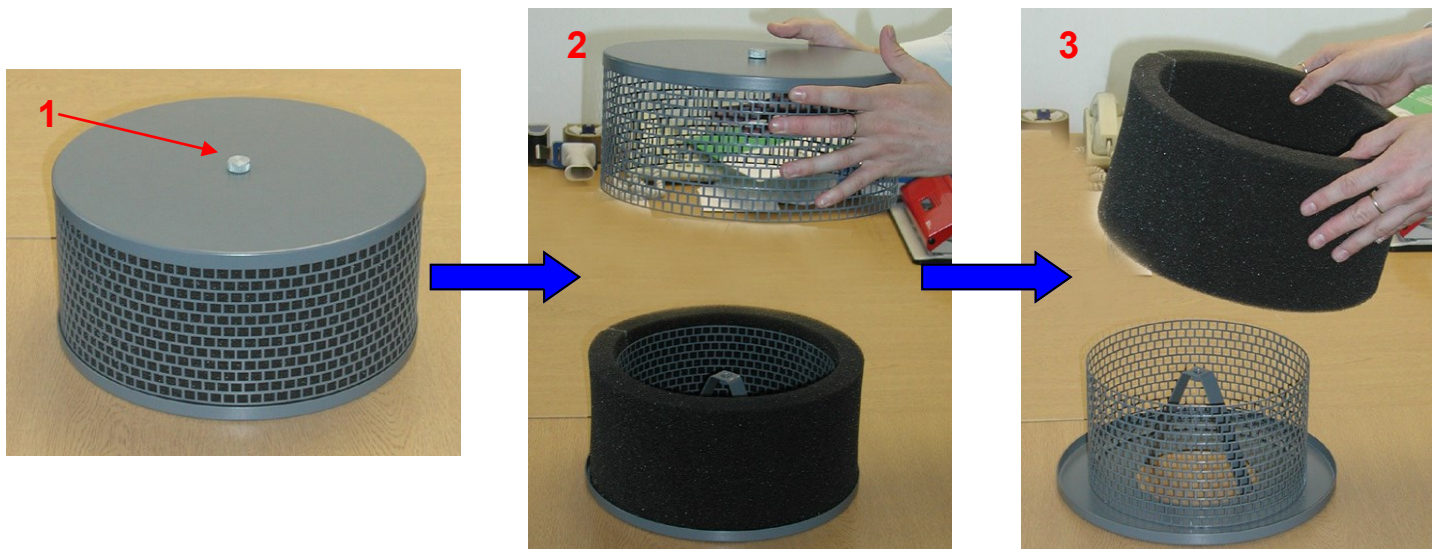

EMCEL FILTERS LIMITED

Blatchford Road, Horsham, West Sussex, RH13 5RA, United Kingdom

Tel: (01403) 253215 Fax: (01403) 217011

www.emcelfilters.co.uk E-mail: info@emcelfilters.co.uk

